

To register, select one of the following:

- Mail the completed form with a check or your bankcard information to:
Salem College
Fleer Center for Adult Education, CFC Program
601 South Church Street
Winston-Salem, NC 27101
- Telephone 336/721-2855, 8:30 a.m. - 5:00 p.m., with bankcard information.
- In person with check, cash or bankcard at the Fleer Center for Adult Education office, Main Hall, first floor.

Confirmation: A confirmation letter will be sent to you following Salem's receipt of your registration and payment. Late registrants should call 336/721-2855 or 336/721-2669 if they have not received confirmation before the course begins to obtain information about course location (if not specified in course description).

Parking: Park in the Fine Arts Center [FAC] parking lot, around the Old Salem Square or at the Old Salem Visitor's Center. Please observe posted parking regulations.

Schedule Changes: Registrants are informed of course cancellations or changes. If we are unable to reach you by phone or email, a notice is posted at the place of meeting, or in the front lobby of Main Hall.

Inclement Weather: Call the main switchboard 336/721-2600, listen to local TV or radio stations for inclement weather advisories or visit www.salem.edu for details.

Withdrawals & Refunds: Registrants who withdraw from a course receive a refund, less a \$25 non-refundable administration fee, if they notify the Fleer Center/CfC in writing (email, mail or in person) at least three (3) business days prior to the beginning of class. No refunds are given after that period unless the course is cancelled by Salem College, in which case, a full refund will be issued.

Continuing Education Units: CEUs are awarded, based on participation in courses, at one unit per 10 hours of attendance. They must be applied for when registering. Not all courses carry CEUs. Please notify the CfC office if you need verification documents.

Bookstore: If a book is required but is not included in the course fee, you may find it at your favorite bookstore. Order early to make certain you have it for the first class.

Enjoy a sense of renewal this spring and learn something new! Registrations are open and ongoing. Call 336/721-2855 to register.

Courses for Community Registration (PLEASE PRINT)

NAME _____ PARENT NAME IF UNDER 18 YEARS OLD _____

ADDRESS _____ CITY _____ STATE _____ ZIP _____

PHONE _____ E-MAIL _____

TOTAL NUMBER OF COURSES _____ TOTAL AMOUNT DUE \$ _____

METHOD OF PAYMENT: CHECK (MADE PAYABLE TO SALEM COLLEGE) CREDIT CARD (VISA OR MASTERCARD)

CARD NUMBER _____ EXPIRATION DATE _____ V-CODE _____

NAME ON CARD _____ SIGNATURE _____

Course #	Course Name	Fee	Start Date
01SP12	SAT Prep Math - Option I	\$225	1/31
02SP12	SAT Prep Critical Reading and Writing Option - I	\$225	2/2
03SP12	Introduction To Wine	\$80	2/13
04SP12	Bridge: Lessons - Play of the Hand, 21st Century	\$80	2/20
05SP12	Shoes Make the Artist - Option I	\$110	2/13
06SP12	Shoes Make the Artist - Option II	\$110	2/13
07SP12	Three-Course Dance Buffet	\$50	2/14
08SP12	Mindful Eating: Nurture Your Body and Spirit	\$45	2/14
09SP12	Everyone Can Draw Workshop - Option I	\$110	2/14
10SP12	Everyone Can Draw Workshop - Option II	\$110	2/15
11SP12	Relax and Paint Workshop - Option I	\$130	2/15
12SP12	Reclaiming the Art of Letter Writing	\$30	2/15
13SP12	Creating Capable Kids	\$60	2/15
14SP12	Spanish for Beginners...Relaxed	\$80	2/16
15SP12	Intermediate Bridge - Conventions and Defensive Strategies	\$80	2/16
16SP12	Anyone Can Write	\$80	2/21
17SP12	Introduction to Social Ballroom Dancing	\$55	3/1
18SP12	Hip Hop Kiddie Movers	\$60	3/1
19SP12	Aging in America	\$40	3/5
20SP12	Wines of Europe	\$85	3/6
21SP12	Trotting Tuesdays at Cash Lowell	\$165	3/6
22SP12	The History and Mystery of Tea - Tea and Chocolate Pairings	\$35	3/6
23SP12	Public Speaking: What Was I So Afraid Of?	\$35	3/7
24SP12	The Art of Couponing - Option I	\$30	3/8
25SP12	Watercolors: Small Paintings, Big Results	\$130	3/26
26SP12	Personal Adornments with Wire	\$45	3/27
27SP12	Raining Cats and Dogs	\$130	3/27
28SP12	SAT Prep Math - Option II	\$225	3/27
29SP12	Relax and Paint Workshop Option II	\$130	3/28
30SP12	SAT Prep Critical Reading and Writing Option - II	\$225	3/29
31SP12	Gourmet Gardening	\$45	3/29
32SP12	Comparing Wine Varieties Around the World	\$85	3/29
33SP12	Learn How To Sell On eBay	\$35	4/2
34SP12	The Art of Couponing - Option II	\$30	4/3
35SP12	Heirloom Gardening	\$45	4/3
36SP12	Facebook Phobia: Get Over It!	\$40	4/5
37SP12	Salem College Wine Dinner at Noble's Grille	\$85	4/9
38SP12	Healing Words: Writing to Heal and Grow	\$80	4/10
39SP12	The Beginning Blogger and Social Media 101	\$55	4/11
40SP12	Introduction to Children's Publishing	\$75	4/19
41SP12	Focus On... Organizing a Wine Cellar	\$85	4/24

Self-mailing directions

- 1) Remove registration form from brochure by cutting along the dotted line.

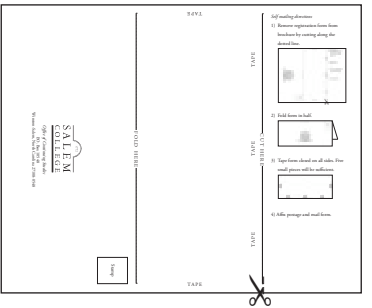

- 2) Fold form in half.



- 3) Tape form closed on all sides. Five small pieces will be sufficient.



- 4) Affix postage and mail form.

T A P E

C U T H E R E

T A P E

T A P E

T A P E

F O L D H E R E

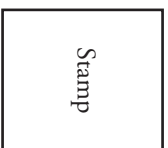

The Fleet Center for Adult Education
CFC Program
601 South Church Street
Winston-Salem, North Carolina 27101

The Salem Campus

- 1 Shober House
- 2 Salem Square
- 3 Inspector's House
- 4 Home Moravian Church
- 5a Main Hall
- 5b Public Safety
- 6 South Residence Hall
- 7 History Wing
- 8 Penn Alumnae House
- 9 Single Sisters House**
- 10 Clewell Residence Hall
- 11 Lehman Hall
- 12 Gramley Library**
- 13 Babcock Residence Hall
- 14 Bahnon House Residence Hall
- 15 Gramley Residence Hall
- 16 Tennis Courts
- 17 Physical Plant Building
- 18 Strong Residence Hall
- 19 Bitting Residence Hall
- 20 Corrin Refectory
- 21 Athletic Facilities
- 22a Fitness Center/Salem Commons
- 22b Bryant Hall
- 23 Rondthaler Science Building
- 24 May Dell
- 25 Rondthaler-Gramley House
- 26 Hanes House
- 27 Salem Fine Arts Center**
- 28 Salem Academy
- 29 Boner House
- 30 Field 5
- 31 Field 4
- 32 Blixt Fields
- 33 Fogle Flats

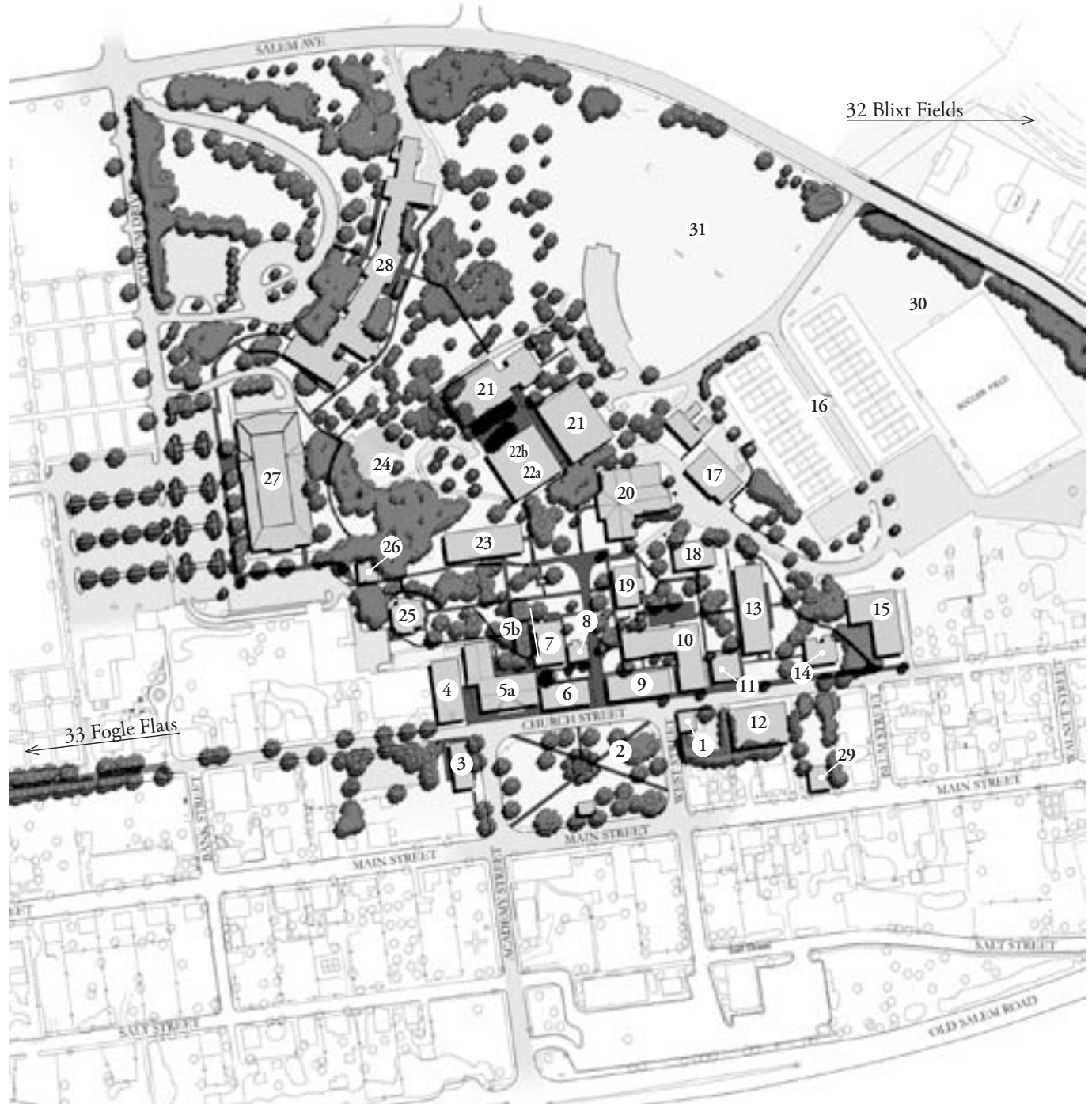

General Information: Cultural Events at Salem College

Free and Open to the Public

Admission to cultural events is free and open to the public unless otherwise specified in the description.

Special Needs

The main level of the Salem Fine Arts Center, including restrooms, is accessible by wheelchair. Wheelchair seating is available in both Shirley Recital Hall and Hanes Auditorium, located inside of the Salem Fine Arts Center.

Late Seating

Late seating opportunities will vary according to the program. Once a program has begun, late seating opportunities are limited and may be delayed until an appropriate time. Be sure to plan your arrival time to allow for traffic and parking. For your convenience, we recommend that you arrive at least 20 minutes before the announced start-time.

General Admission Seating

All of the auditoriums at Salem College are open seating which means there will be no seats that are specifically reserved except in special circumstances.

Electronic Courtesy

Please remember to turn off all pagers, cell phones, electronic watch alarms, or other beeping/ringing devices before entering the auditorium. Recording devices of any type are not permitted in Salem College performance venues.

Gentle Reminder

Tobacco, food and beverages are strictly prohibited inside of Salem College performance venues.

Directions to Salem Facilities

Directions to the Salem College Fine Arts Center Parking Lot: Hanes Auditorium, Shirley Recital Hall and the Drama Workshop are located inside of the Salem Fine Arts Center.

From West of Winston-Salem

Take I-40 East to Winston-Salem. When I-40 splits, take Business 40. From Business 40, take the Salem College/Old Salem exit. When the ramp forks, take the right fork to the yield sign at the end of the ramp. Turn left. Go to the first intersection and turn left onto Cemetery Street. Follow Cemetery Street until it dead-ends at Salem Avenue. Turn right onto Salem Avenue. At the first traffic light, turn right into the Salem Fine Arts Center entrance. There is a large parking lot at the bottom of the hill.

From Greensboro/East of Winston-Salem

Take I-40 West to Winston-Salem. When I-40 splits, take Business 40. From Business 40, take the Old Salem/Salem College exit, which is US 52 South. Take the Salem College/Winston-Salem State/Stadium Drive exit off of 52 South. At the end of the ramp, turn right onto Stadium Drive. When you reach the traffic light at the top of the hill, go straight into the Salem Fine Arts Center entrance. There is a large parking lot at the bottom of the hill.

Directions to the Saal in Single Sisters House and the Library Assembly Room in Gramley Library

From I-40 West

After passing the airport exit, take Exit 206 for Interstate 40 Business to Kernersville/Downtown Winston-Salem. When approaching Winston-Salem, go past Highway 52 and take the next exit at Main Street. Turn right on Main Street. Go one block and turn left at First Street. Go one block and turn left at Liberty Street. At the third stoplight, turn left onto Academy Street, which brings you into the Salem Square. The **Single Sisters House** is the second building on the left after you pass Main Hall; the Saal is located on the second floor. **Gramley Library** is the second building on the right after you pass the Salem Square; the Library Assembly Room is located on the third floor and there is elevator access.

From I-40 East

Take I-40 West to Winston-Salem. When I-40 splits, take Business 40. From Business Take Interstate 40 Business to Winston-Salem (not I-40 Bypass). Exit at Old Salem/Salem College/Downtown exit. At the third stoplight, turn left on Academy Street, which brings you into the Salem Square. The **Single Sisters House** is the second building on the left after you pass Main Hall; the Saal is located on the second floor. **Gramley Library** is the second building on the right after you pass the Salem Square; the Library Assembly Room is located on the third floor and there is elevator access.

From Highway 52

Exit at Stadium Drive/Old Salem/Salem College Exit. Go west on Stadium Drive. Go to first stoplight (entrance to Salem Academy and Fine Arts Center). Turn left on Salem Avenue. Enter the traffic circle and take the first right on Old Salem Road. At the next light turn right on Academy Street, which brings you into the Salem Square. The **Single Sisters House** is the second building on the left after you pass Main Hall; the Saal is located on the second floor. **Gramley Library** is the second building on the right after you pass the Salem Square; the Library Assembly Room is located on the third floor and there is elevator access.